

Model:
FCI-82-SC

Counter Height Deli Display Case

Cooler

Stainless

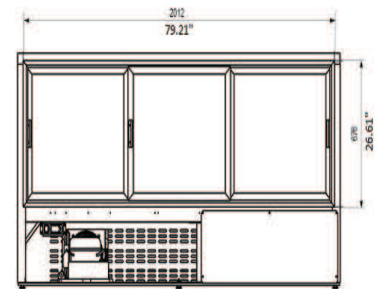
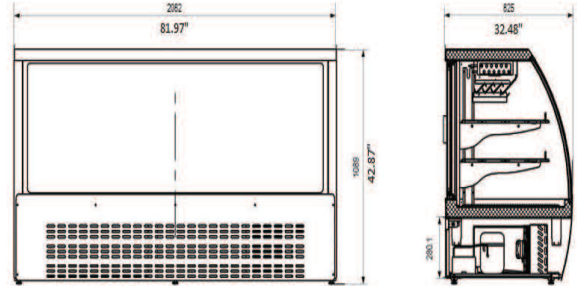

5-15P



Doors	Shelves	Refrigerant	HP	Power	Amps.	Cu.ft.	Weight(lbs.)
3	9	R290	1/2	115/60/1	6.3	32	350

FEATURES

- Cabinet Construction**
 - ✓ Exterior – Stainless Steel Top and front, coated steel sides.
 - ✓ Interior - Attractive, aluminum liner with stainless steel floor.
- Rounded corner** design inside of the cabinet makes it easy to clean it.
- Standard door features:**
 - ✓ Double pane glass for thermal protection.
- Refrigeration system:**
 - ✓ Gravity coil refrigeration system provides high humidity environment for meats and deli products.
 - ✓ Holds 32°F to 43°F (0.5°C to 5°C).
- Electronic control system:**
 - ✓ Adjustable temperature set point and defrost frequency.
 - ✓ Error codes to diagnose service issues.
- Shelves:** Adjustable, heavy duty PVC coated shelves.
- Standard heavy-duty casters** make it easy to move and clean underneath.
- "No Stoop" lower shelf.
- Easily accessible condenser coil for cleaning, and easy service access.
- Simple installation with no plumbing required.