

Model:
BBCI-6024G

24" Wide Back Bar

Cooler

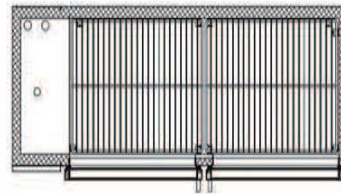
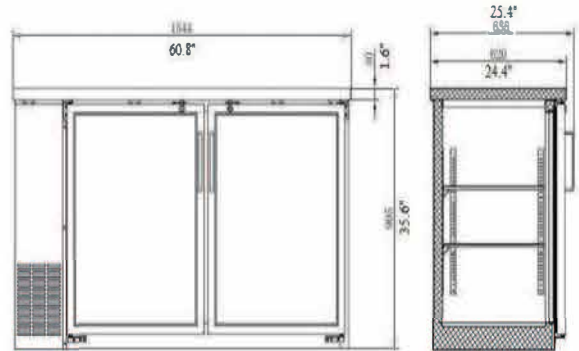

R290



5-15P

Doors	Shelves	Refrigerant	HP	Power	Amps.	Cu.ft.	Weight(lbs.)
2	4	R290	1/3	115/60/1	6.4	15.8	250

FEATURES

- Cabinet Construction standard:**
 - ✓ Exterior includes attractive, wear resistant vinyl on steel in black finish.
 - ✓ Internal standard construction utilizes stainless steel walls, floor and ceiling.
- Refrigeration system:**
 - ✓ Uses R290 which is CFC and HCFC-free to protect the environment.
 - ✓ Holds 33°F to 38°F (0.5°C to 3.3°C) for the best in food preservation.
- Electronic control system:**
 - ✓ Plug-in directly 115/60/1, 15amp.
- Sanitation:** SNF-7 approved for packaged and bottled product.
- LED light:** inside in cabinet.
- Easily accessible condenser coil for cleaning, and easy service access.
- Simple installation with no plumbing required.
- Designed to accommodate a variety of beer kegs.